

## 双板立柱DS2 Double-plate Pillar DS2

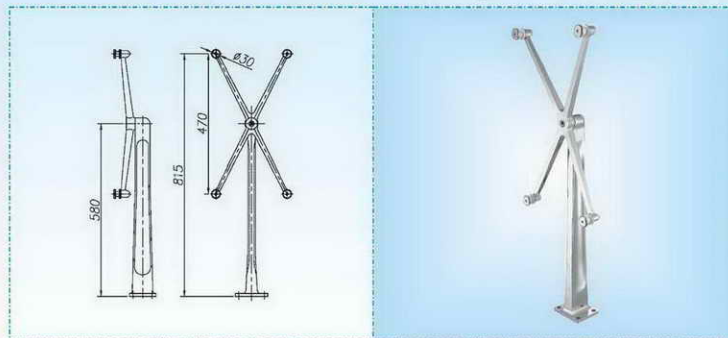

## Casting Pillar DZ1 铸造立柱DZ1



### ●玻璃夹标配B03P、驳接爪标配T05 Glass Clamp with B03P, Balustrade Bracket with T05

配玻璃夹结构图和顺序号 Glass Clamp structure drawing with sequence number					
A1	A2	A3	A4	A5	A6
配驳接件结构图和顺序号 Balustrade Bracket structure drawing with sequence number					
B1	B2	B3	B4	B5	B6

注：A2与A3、A5与A6、B2与B3、B5与B6为同类立柱。  
Note: A2&A3,A5&A6,B2&B3,B5&B6 are same type pillars.

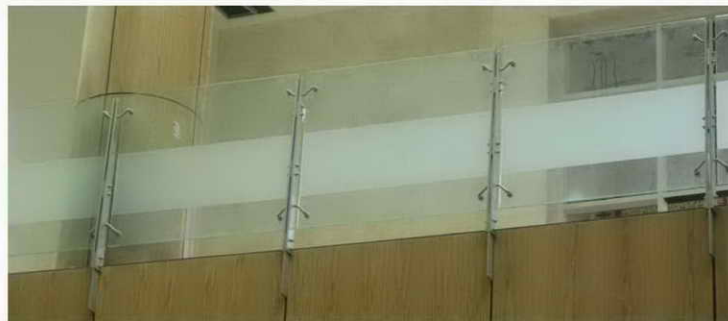

# 玻璃隔断支撑件 Glass Balustrade Fitting

玻璃隔断安装图  
Installation Diagram of Glass Balustrade

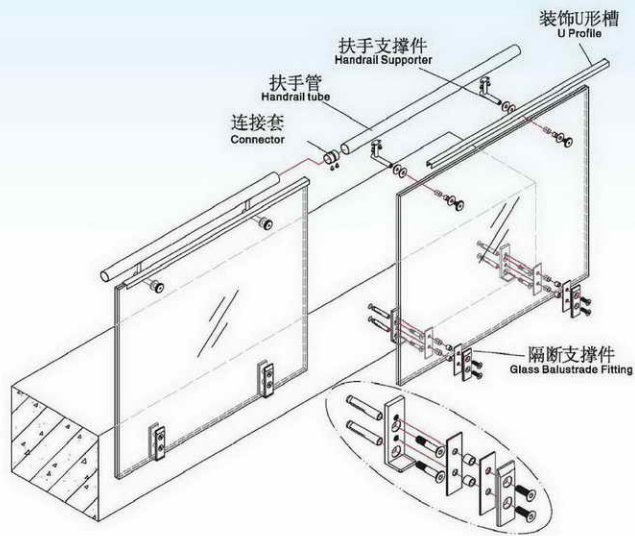

注：承受水平荷载的栏板玻璃公称厚度不小于12mm的钢化玻璃或公称厚度不小于16.76mm的钢化夹层玻璃，当栏板玻璃最低点高一侧楼地面的高度在3m或3m以上，5m或5m以下时应使用公称厚度不小于16.76的钢化玻璃，当栏板玻璃最低点高一侧楼地高度大于5m，不得使用承受水平荷载的栏板玻璃。（引用JGJ 113-2009《建筑玻璃应用规程》）

Note: Over 12mm tempered glass or 16.76mm laminated glass should be used when the glass has horizontal load. Over 16.76mm tempered glass should be used when the distance (between the bottom of the balustrade glass and ground) is from 3m to 5m. It's prohibited to use horizontal loading glass when the distance (between the bottom of the balustrade glass and ground) is over 5m... (Note: Above mentioned items are quoted from JGJ 113-2009 Technical specification for application of architectural glass)

## Glass Balustrade Fitting 玻璃隔断支撑件

YM01

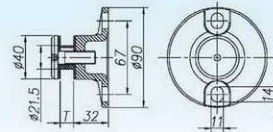

YM02

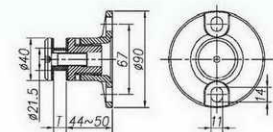

YM03

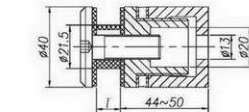

YM04(FS-42)

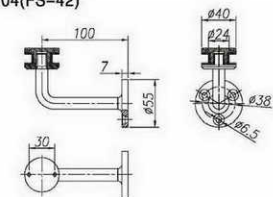





玻璃隔斷支撐件 Glass Balustrade Fitting

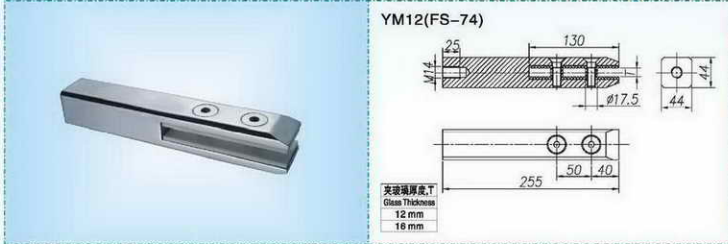
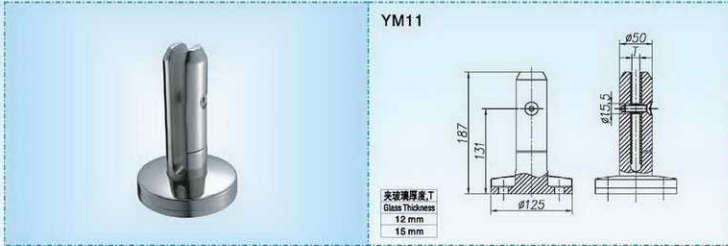

Glass Balustrade Fitting 玻璃隔斷支撐件

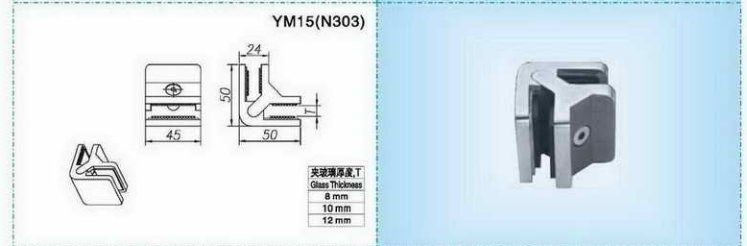
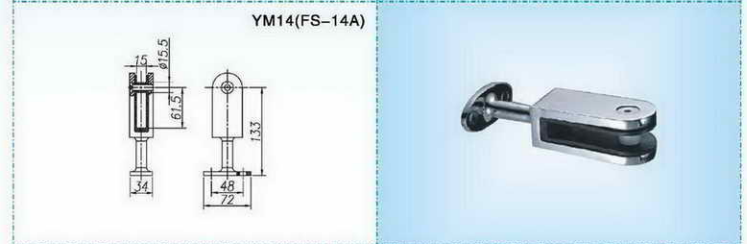
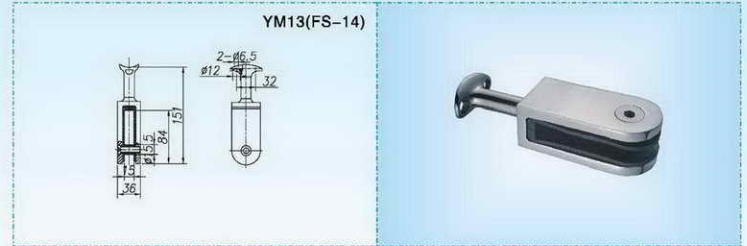

## 玻璃隔斷支撐件 Glass Balustrade Fitting

