

转接件 Connector

• 型号规则

Principle for making the model number

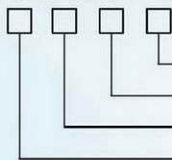

- 顺序号(阿拉伯数字); The same type No.(Arabic Numeral)
- 外观代号(大写字母); The appearance code(Capital Letter)
- 螺栓公称直径(阿拉伯数字); The diameter of the bolts(Arabic Numeral)
- 名称代号(大写字母), S为过索式。S stands for cable connector

• 技术要点

Technical main points

① 过索式转接件压索螺栓拧紧力矩计算(由机械设计手册推导)

The calculation for the tightening moment of cable connector bolt for pressing the tension cable (deriving from the machine design handbook)

$$T=1.3fd/n$$

式中 T — 单个螺栓拧紧力矩(N · mm) The tightening moment for a single bolt (N · mm)

f — 配件在工程节点中需承受的摩擦力(N);
The friction force which the accessories should load on the project node.

d — 压索螺栓公称直径(mm); The diameter of the bolt for pressing the tension cable(mm)

n — 压索螺栓数目。 The number of the bolts for pressing the tension cable.

② 紧定防转设计 Adaptive and anti-rotating design

转接件的外螺母上有一紧定螺钉, 内螺母上有一道紧定槽(图1), 当内螺母调整好距离后, 将紧定螺钉顶在紧定槽内。此种设计适用于转接件受到左右不均荷载的工程节点(图2), 可有效防止转接件受力转动。

There is a set screw on the outer nut of the connector. A set groove is on the inner nut(the 1st drawing). After the distance of the inner nut has been adjusted, put the set screw in the set groove. This kind of design can be adopted to the project node when the connector loads the imbalance force. This also prevents the connector from rotating when it loads force.

注: 大部分焊接式转接件均可在原有产品基础上增加此项功能。

Note: Most connectors of welding style can be re-created to the adaptive and anti-rotating structure on the basis of the original products.



图1
The 1st drawing



图2
The second drawing

③ 除Z61以外, 转接件底座的材质一般为碳素结构钢Q235, 若需要不锈钢时, 请在转接件代号的末尾加注“B”

The material of the base for connectors (Except Z61) is usually the Carbon Constructional Steel Q235. If the material of stainless steel for the base is needed, please add "B" to the end of the connector code.

Z12

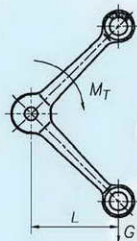
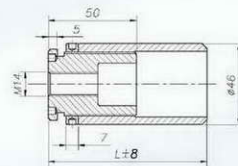

注:L标准长度为90
Note: Standard L=90



Z13

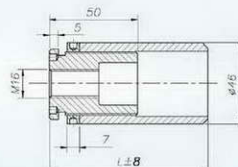

注:L标准长度为90
Note: Standard L=90



Z15

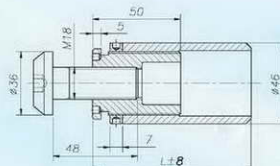

注:L标准长度为90
Note: Standard L=90



Z15L1

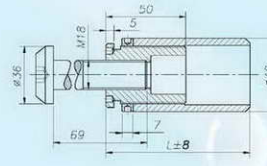

注:L标准长度为90
Note: Standard L=90





Z25

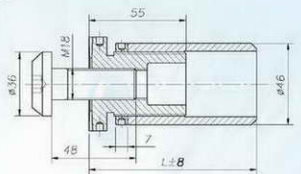

注:L标准长度为95
Note: Standard L=95



Z35

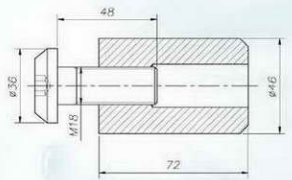

注:L标准长度为113
Note: Standard L=113



Z51

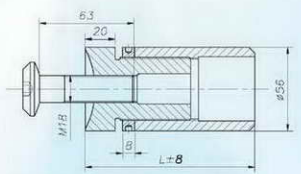

注:L标准长度为113
Note: Standard L=113



Z16

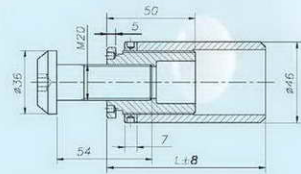

注:L标准长度为90
Note: Standard L=90

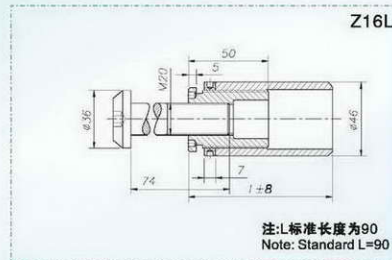

Z16L

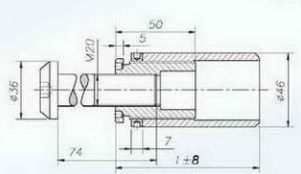

注:L标准长度为90
Note: Standard L=90

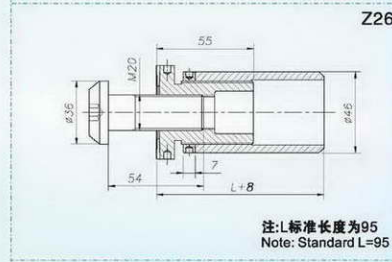

Z26

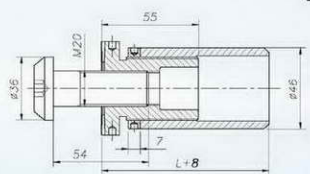

注:L标准长度为95
Note: Standard L=95

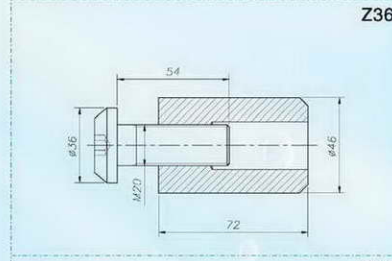

Z36

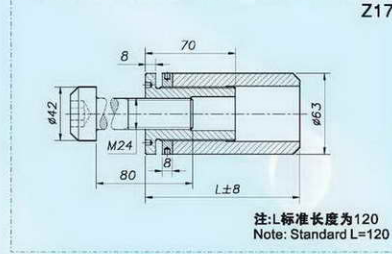
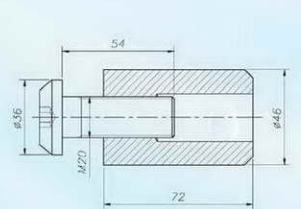

Z17

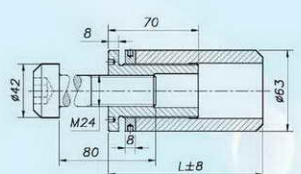

注:L标准长度为120
Note: Standard L=120



S18A31

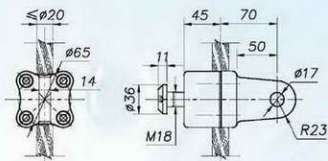

S18A32

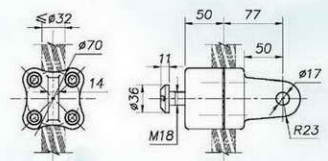

S18A41

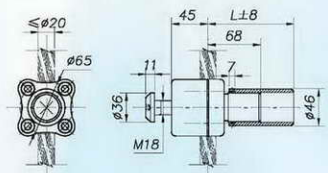

S18A42

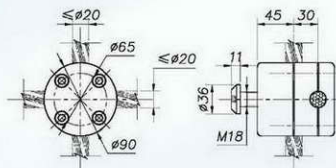
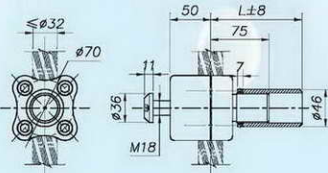

S18B11

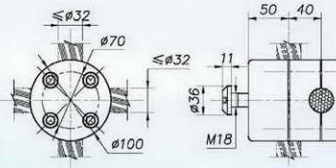

S18B12

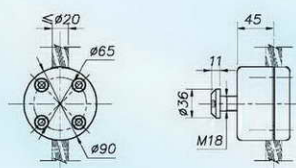

S18B21

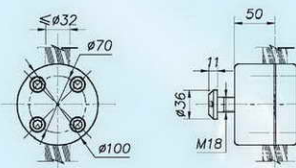

S18B22



转接件 Connector



S18B31

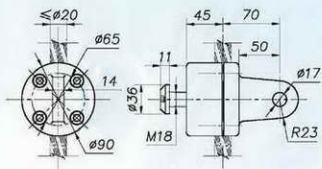

S18B32

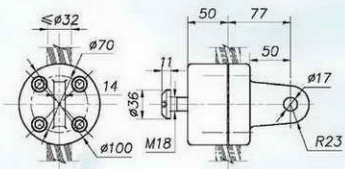

S18B41

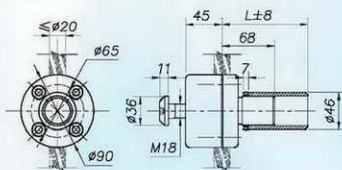

S18B42

